

# HOW TO VIEW AND PRINT PROPERTY TAX INFORMATION

1. Go to the Royal Oak BSA Website: <http://bsaonline.com/?uid=1652> and sign in.

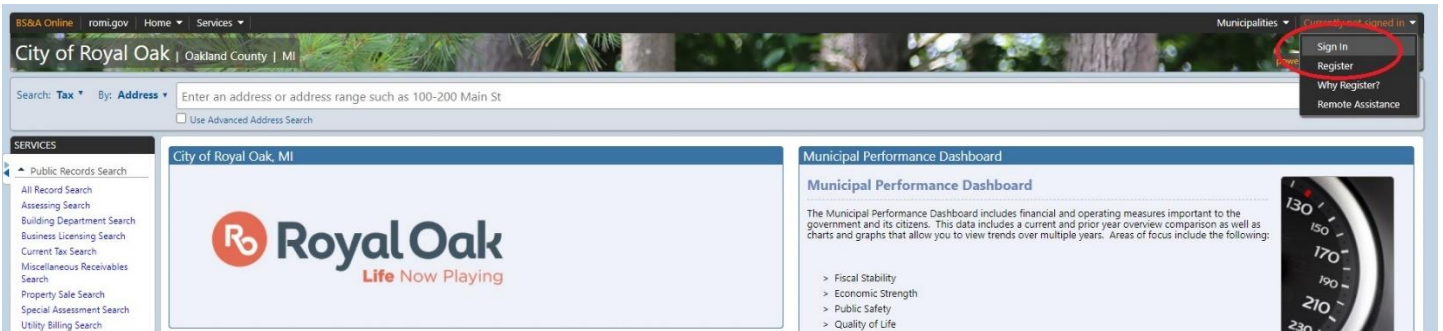

If you have not been to the site before, you will need to register (free of charge to property owners). Instructions to register are here: [https://bsaonline.com/Documents/bsao\\_creatinguseraccount.pdf](https://bsaonline.com/Documents/bsao_creatinguseraccount.pdf)

2. Click on “Current Tax Search.” Enter your address and press “Search”.

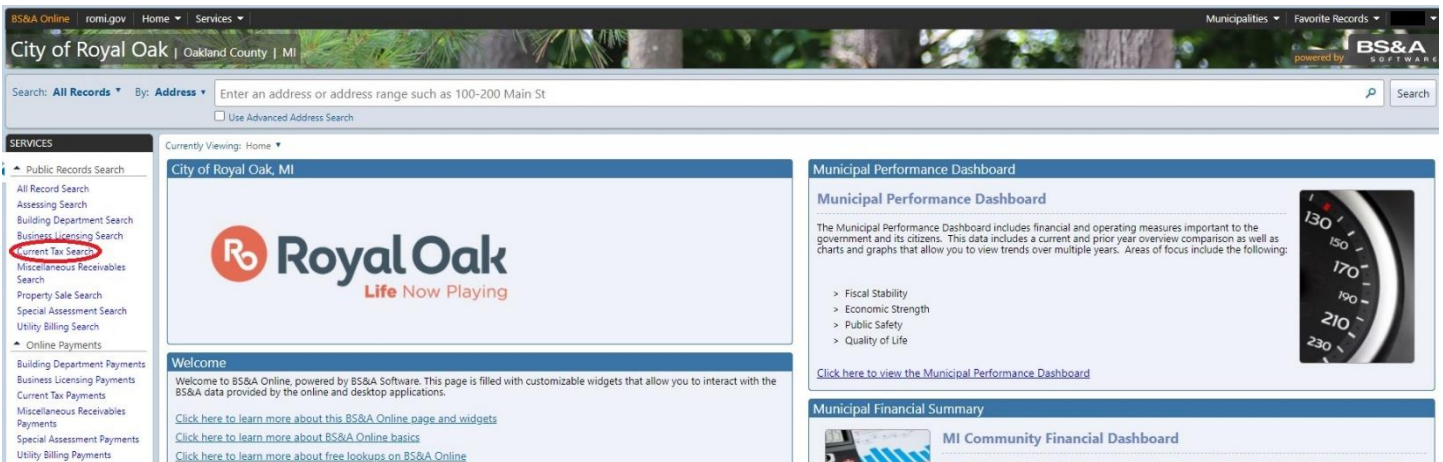

3. Click on the result.

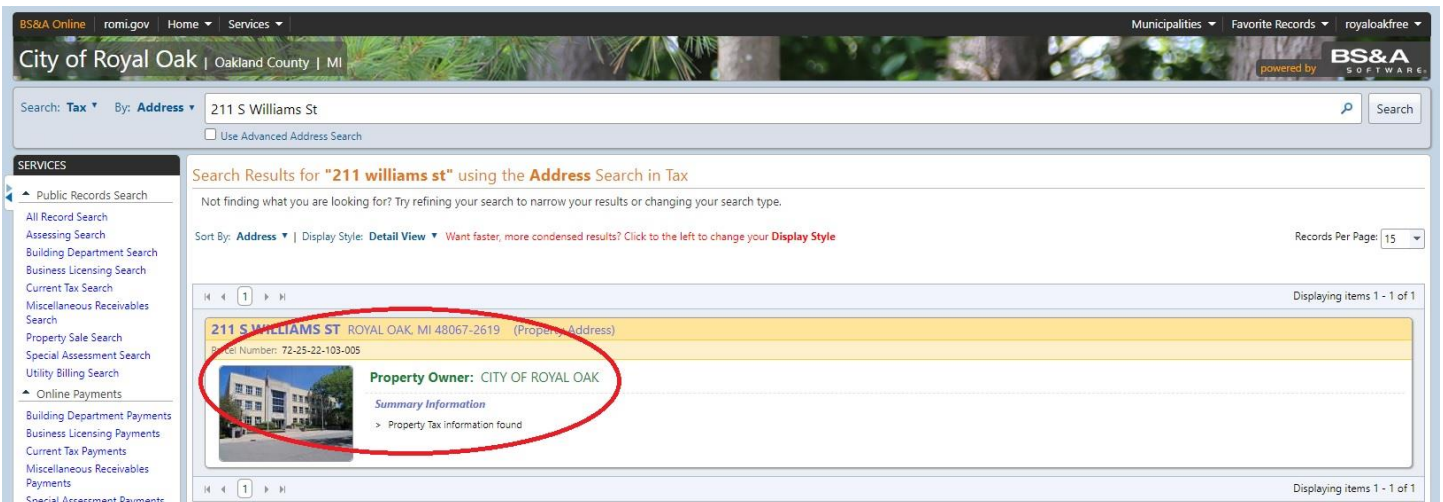

4. Scroll down the page to the "History" Section

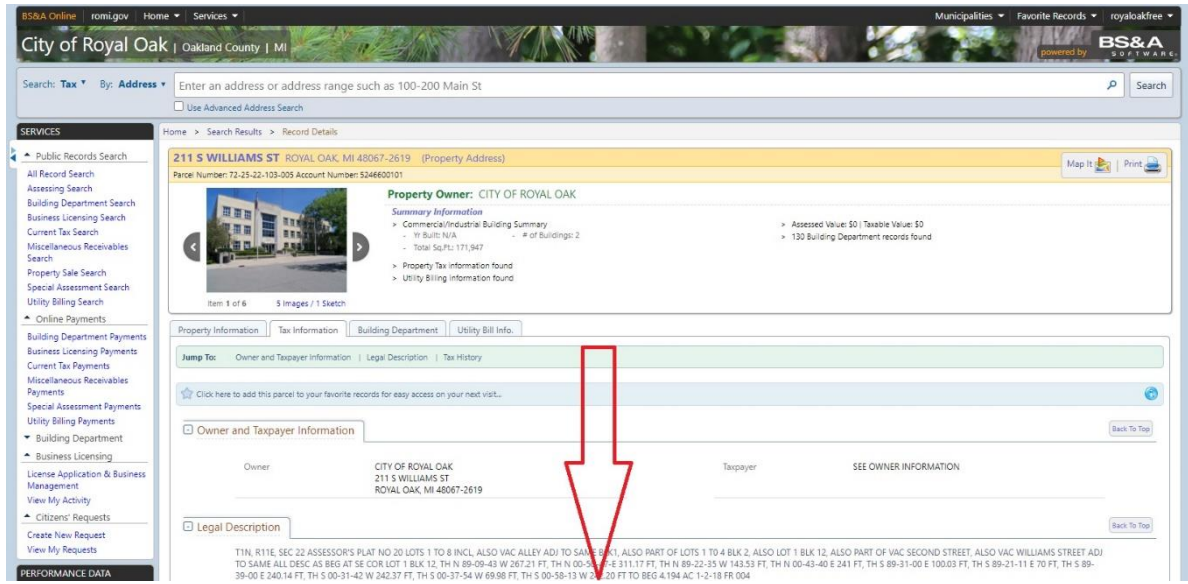

5. Click the triangle next to the bill of your choice to bring up tax information.

Recalculate amounts using a different Payment Date  
 You can change your anticipated payment date in order to recalculate amounts due as of the specified date for this property.

Enter a Payment Date:

Tax History

|  | Year   | Season | Total Amount | Total Paid | Last Paid | Total Due |
|--|--------|--------|--------------|------------|-----------|-----------|
|  | ▶ 2020 | Summer | \$0.00       | \$0.00     |           | \$0.00    |
|  | ▶ 2019 | Winter | \$0.00       | \$0.00     |           | \$0.00    |
|  | ▶ 2019 | Summer | \$0.00       | \$0.00     |           | \$0.00    |
|  | ▶ 2018 | Winter | \$0.00       | \$0.00     |           | \$0.00    |
|  | ▶ 2018 | Summer | \$0.00       | \$0.00     |           | \$0.00    |

\*\*Disclaimer: BS&A Software provides BS&A Online as a way for municipalities to display information online and is not responsible for the content or accuracy of the data herein. This data is provided for reference only and WITHOUT WARRANTY of any kind, expressed or inferred. Please contact your local municipality if you believe there are errors in the data.

6. To print, select "Click here for a printer friendly version..." located beneath the tax bill breakdown. The information will be displayed in a printer-friendly format.

Tax Bill Breakdown for 2019 Summer

| Taxing Authority | Millage Rate     | Amount        | Amount Paid   |
|------------------|------------------|---------------|---------------|
| COUNTY OPERATING | 4.040000         | \$0.00        | \$0.00        |
| ISD VOTED        | 3.060500         | \$0.00        | \$0.00        |
| ISD ALLOCATED    | 0.193400         | \$0.00        | \$0.00        |
| COLLEGE          | 1.530300         | \$0.00        | \$0.00        |
| STATE EDUCATION  | 6.000000         | \$0.00        | \$0.00        |
| SCHOOL OPERATING | 18.000000        | \$0.00        | \$0.00        |
| SCHOOL SUPPLMNTL | 2.094300         | \$0.00        | \$0.00        |
| SINKING FUND     | 0.956800         | \$0.00        | \$0.00        |
| SCHOOL DEBT      | 3.000000         | \$0.00        | \$0.00        |
| CVT OPERATING    | 7.062500         | \$0.00        | \$0.00        |
| PUBLICITY TAX    | 0.016900         | \$0.00        | \$0.00        |
| FIRE             | 0.227000         | \$0.00        | \$0.00        |
| LIBRARY          | 0.916300         | \$0.00        | \$0.00        |
| REFUSE STATE LAW | 1.925600         | \$0.00        | \$0.00        |
| REFUSE VOTED     | 0.701600         | \$0.00        | \$0.00        |
| DDA              | 1.602100         | \$0.00        | \$0.00        |
| Admin Fees       |                  | \$0.00        | \$0.00        |
| Interest Fees    |                  | \$0.00        | \$0.00        |
|                  | <b>51.327300</b> | <b>\$0.00</b> | <b>\$0.00</b> |

[Click here for a printer friendly version of Summer 2019 Tax information](#)